

Rotating cleaning nozzle HygienicWhirly Series 594/595



Features:

- Cleaning with effective flat fan jets
- Effective cleaning even at low pressure
- Suitable for foam delivery



Function video
www.lechler.com/de-en/medialibrary/videos-general-industry
 Or scan the QR code.

Series 594/595

Technical data:



Maximum operating temperature
150 °C



Maximum ambient temperature
150 °C



Installation
Operation in every installation position



Bearing
Slide bearing made of PEEK



Material
Stainless steel 1.4404 (316L), PEEK, version with slip-on connection: O-ring made of EPDM



Weight
90–290 g



Surface quality
Ra ≤ 0.8 µm
OUTSIDE



Surface quality
Ra ≤ 0.8 µm
INSIDE



Steam suitability
Suitable



Insertion diameter
31.5–48.0 mm



Recommended filter
Line strainer with a mesh size of 0.3 mm/50 mesh



Recommended operating pressure
3 bar



Max. tank diameter
The specified maximum tank diameter applies to the recommended operating pressure and is indicative only. The type of soiling is also decisive for the cleaning result.

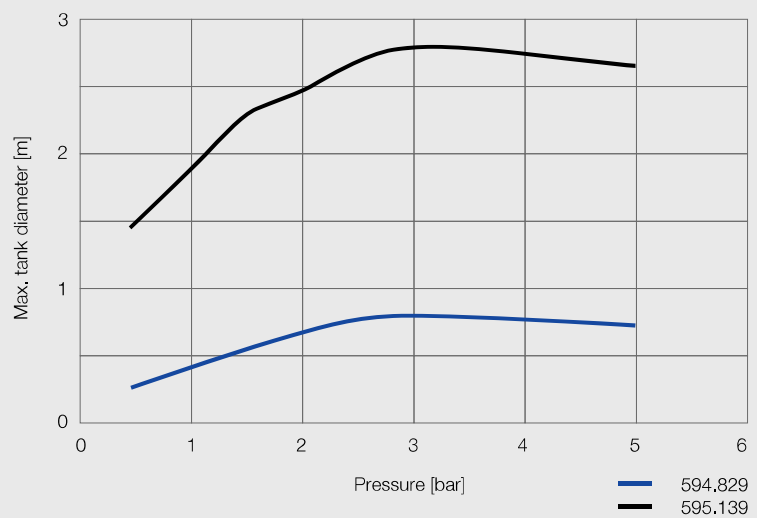

Overview of maximum tank diameter depending on pressure

Dimensions in mm.

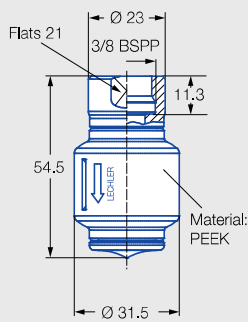

**Standard version
Female thread
59x.xx9.1Y.AF**

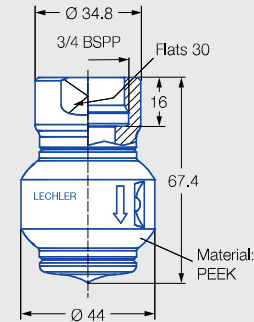

**Standard version
Female thread
595.139.1Y.AL**

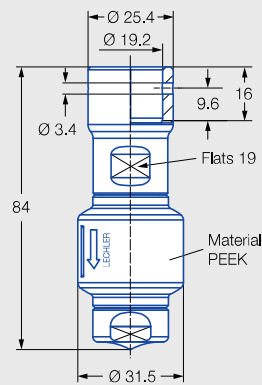

**Dimensions of slip-on
connection according to
ASME-BPE (OD tube)
59x.xx9.1Y.67**

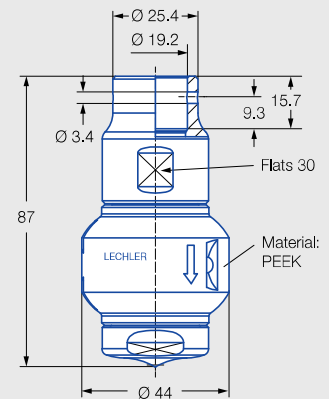

**Dimensions of slip-on
connection according to
ASME-BPE (OD tube)
595.139.1Y.67**

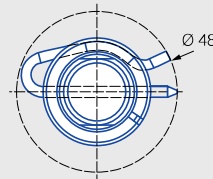

**Insertion diameter
of slip-on connection
59x.xx9.1Y.67**

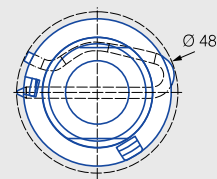

**Insertion diameter
of slip-on connection
595.139.1Y.67**

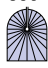
Spray angle	Ordering no.				Narrowest cross-section Ø [mm]	V̇ water [l/min]					Max. tank diameter [m]	
	Type	Connection				p [bar] (p _{max} = 5 bar)						
		3/8 BSPP	3/4 BSPP	3/4" slip-on connection		0.5	1.0	2.0	3.0	5.0		V̇ water at 3 bar [m³/h]
 360°	594.829.1Y	AF		67	1.7	6	8	11	14	18	0.8	0.8
	594.879.1Y	AF		67	2.5	8	11	15	18	23	1.1	1.2
	595.009.1Y	AF		67	4.0	16	22	32	39	50	2.3	1.5
	595.049.1Y	AF		67	4.2	20	28	40	49	63	2.9	2.0
	595.139.1Y		AL	67	5.0	34	47	67	82	106	4.9	2.7

NPT threads on request.

Information on operation

Compressed air can be used only for a short time for blowing dry. Use above the recommended pressure will have a negative effect on the cleaning result and wear.

Information on slip-on connection

- Cotter pin made of stainless steel 1.4404 (316L) included (ordering no. 095.022.1Y.50.94.E).
- Depending on the adapter diameter, the flow rate may increase due to the leakage between the adapter and rotating cleaning nozzle.

Ordering Type + Connection = Ordering no.
example: 594.829.1Y + AF = 594.829.1Y.AF